



CHUMACERAS Y REPUESTOS	Pag.
SERIE 200 Browning	A-1
SERIE 300 Browning	A-2
SERIE 100 Browning	A-3
SERIE ER BROWNING	A-4
SERIE 200 Browning MILIMETRICAS	A-5
LINEA DE ORO SealMaster TRABAJO NORMAL.....	A-6
LINEA DE ORO SealMaster TRABAJO MEDIO.....	A-7
LINEA DE ORO SKWEZLOC TRABAJO NORMAL	A-8
LINEA DE ORO SKWEZLOC TRABAJO MEDIO	A-9
LINEA DE ORO REPUESTOS Y ER	A-10
LINEA DE ORO SealMaster MILIMÉTRICAS	A-11
ANTICORROSIVAS CRES SealMaster.....	A-12
ESPECIALES Y TENSORES SealMaster.....	A-13
CHUMACERAS DE RODILLOS CONICOS	A-14
CHUMACERAS DE RODILLOS ESFERICOS	A-15



TRANSMISIÓN DE POTENCIA

CADENA DE RODILLOS SENCILLA, DE ACERO INOXIDABLE Y EXTRA CAP.	B-1
CADENA DE RODILLOS DOBLE	
CORTADORES Y TENSOR	B-2
CADENA TRIPLE, CUADRUPLE, 5 Y 6.....	B-3
CADENA SILENCIOSA, HY-VO, DELRIN, BL Y ROLLERLESS PARA MONTACARGAS	B-4
CLUTCHES MORSE	B-5
LIMITADORES DE TORQUE MORSE	B-6
ROTULAS SealMaster.....	B-7
POLEAS BKH PARA BUJE H	B-8
POLEAS BK BARRENO A LA MEDIDA	B-9
POLEAS B5V PARA BUJE B	B-10
POLEAS DE PASO VARIABLE	B-11
REDUCTORES MONTADOS SMTP Plus	B-12
PARTES PARA REDUCTORES SMTP	B-13
REDUCTORES MONTADOS SMT Y PARTES	B-14
REDUCTORES SINFIN-CORONA RAIDER	B-15
ACCESORIOS PARA REDUCTORES RAIDER.....	B-16
REDUCTORES SINFIN-CORONA ACERO INOX	B-17
REDUCTORES EN-LINEA BC7000 Brida-C.....	B-18
REDUCTORES EN-LINEA BC7000 Flecha.....	B-19
REDUCTORES HELICOIDALES 90° OtN3000.....	B-20
MOTORES TRIFASICOS WEG	B-21
MOTORES MONOFASICOS WEG	B-22

SERIES EN MILIMETROS	Pag.
SERIES: 600, 620, 6000, 6200, 6300, 6400.....	C-1
61900, 1726200	
DOBLE HILERA 4200B, 4300B	C-2
CONT. ANGULAR 7200B	C-3
7300B, 7400B, SERIE 100, 51106	C-4
DOBLE HILERA 3200B, 3300B	C-5
SUPERPRECISION, CONT. ANG.	
SERIES 7900, 7000, 7200, 7300	C-6
SUPERPRECISION BSB SOPORTES.....	C-7
CILINDRICOS NU, NJ, N 200	C-8
CILINDRICOS NU, NJ, N 300	C-9
ESFERICOS DOBLE HILERA	
SERIES 21300, 22200, 22300, 23000, 23200	
22300 PARA CRIBAS VIBRATORIAS	C-10

SERIES EN PULGADAS

R, XLJ, LJ, MJ	C-11
DOBLE HILERA	
AUTOALINEABLE NLJ, NMJ	C-12
UNA HILERA CONT. ANG.	
LJT, MJT. Y ESPECIALES:	
QJM, LT, LTW, LSN	C-13
RODILLOS CILINDRICOS	
XLRJ, LRJ, MRJ	C-14

CHUMACERAS Y REPUESTOS

CHUMACERAS MILIMETRICAS	C-15
REPUESTOS 1000, 1200, 1100 ER	C-16
CHUMACERAS ACERO INOXIDABLE	C-17



BANDAS INDUSTRIALES

BANDAS A, B	D-1
BANDAS C, D, E	D-2
BANDAS AX, BX	D-3
BANDAS 3V, 5V, 8V	D-4
BANDAS 3VX, 5VX	D-5
BANDAS 3L, 4L, RPF	
MEDIDORES DE BANDAS	D-6
BANDAS AA, BB, CC	D-7



LISTA DE PRECIOS

**CHUMACERAS Y REPUESTOS
SERIE 200 TRABAJO NORMAL**

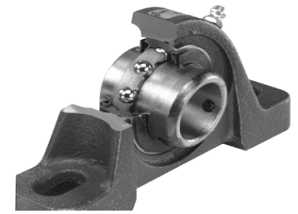

SERIE 200

EQUIVALENTES	BASE	BRIDA 2T	BRIDA 4T	TENSORA	BRIDA RED.	B. ROSCADA
BROWNING 200	VPS-200	VF2S-200	VF4S-200	VTWS-200	VFCS-200	VTBS-200
DODGE	P2B-SC	F2B-SC	F4B-SC	WSTU-SC	FC-SC	TB-SC
SKF	SY-TM	FYT-TM	FY-TM	TBY-TM		
LINK BELT	P3-U200N	FX3-U200N	F3-U200N	TH3-U200N	FC3-U200N	PT3-U200N
FAFNIR	RASC / YAS	RCJTC / YCJT	RCJC / YCJ	RTU / YTU	RFC	

Φ	NUM.	VPS-200	VF2S-200	VF4S-200	VTWS-200	VFCS-200	VTBS-200	VS
1/2	208	\$396	\$396	\$396	\$600		\$396	\$337
5/8	210	\$396	\$396	\$396	\$600		\$396	\$337
3/4	212	\$396	\$396	\$396	\$600		\$396	\$337
7/8	214	\$445	\$445	\$445	\$600		\$445	\$379
15/16	215	\$445	\$445	\$445	\$600		\$445	\$379
1	216	\$445	\$445	\$445	\$600		\$445	\$379
1 1/8	218	\$523	\$523	\$523	\$720	\$786	\$523	\$445
1 3/16	219	\$523	\$523	\$523	\$720	\$786	\$523	\$445
1 1/4	220S	\$523	\$523	\$523		\$786	\$523	\$445
1 1/4	220	\$603	\$603	\$603	\$810	\$899	\$603	\$514
1 3/8	222	\$603	\$603	\$603	\$838	\$899	\$603	\$514
1 7/16	223	\$603	\$603	\$603	\$838	\$899	\$603	\$514
1 1/2	224	\$721	\$721	\$721	\$985	\$1,011	\$721	\$613
1 5/8	226	\$860	\$860	\$860	\$1,102	\$1,276	\$860	\$730
1 11/16	227	\$860	\$860	\$860	\$1,102	\$1,276	\$860	\$730
1 3/4	228	\$860	\$860	\$860	\$1,102	\$1,276	\$860	\$730
1 15/16	231	\$933	\$933	\$933	\$1,266	\$1,421	\$933	\$794
2	232S	\$933	\$933	\$933		\$1,421	\$933	\$794
2	232	\$1,081	\$1,081	\$1,081	\$1,473	\$1,626		\$921
2 3/16	235	\$1,081	\$1,081	\$1,081	\$1,495	\$1,626		\$921
2 1/4	236	\$1,678	\$1,678	\$1,678		\$2,461		\$1,426
2 7/16	239	\$1,678	\$1,678	\$1,678	\$2,044	\$2,461		\$1,426
2 1/2	240							
2 11/16	243			\$4,692				\$3,109
2 15/16	247	\$6,031		\$6,031				\$3,994

Nota: Tamaños 243 y 247 son de origen USA, debe aplicárseles el factor de productos importados.

REPUESTO
VS-200



		VF4B-223	\$2,332
VPS-223AH	\$1,925	VPLS-216	\$1,208



LISTA DE PRECIOS

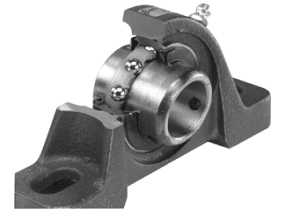

SERIE 300

**CHUMACERAS Y REPUESTOS
SERIE 300 TRABAJO MEDIO**

EQUIVALENTES	BASE	BRIDA 2T	BRIDA 4T	TENSORA	BRIDA RED.	REPUESTO
BROWNING 300	VPS-300	VF2S-300	VF4S-300	VTWS-300	VFCS-300	VS-300
DODGE	P2B-SCM	F2B-SCM	F4B-SCM	WSTU-SCM	FC-SCM	
SKF	SYM-TM	FYTM-TM	FYM-TM	TBYM-TM		
LINK BELT						
FAFNIR	RAKH	YCJTM	YCJM			

Φ	NUM.	VPS-300	VF2S-300	VF4S-300	VTWS-300	VFCS-300	REPUESTO
---	------	---------	----------	----------	----------	----------	----------

1	316	\$1,702					
1 3/16	319						
1 1/4	320						
1 7/16	323	\$1,316		\$1,320	\$1,444	\$1,357	
1 1/2	324	\$1,489		\$1,489	\$1,573	\$1,489	
1 11/16	327	\$1,656		\$1,656	\$1,706	\$1,565	
1 3/4	328	\$1,656		\$1,656	\$1,706	\$1,565	
1 15/16	331	\$2,071		\$2,071	\$2,130	\$2,113	
2	332	\$1,081		\$1,081	\$1,473	\$1,626	
2 3/16	335	\$2,992		\$2,992	\$3,342	\$4,087	
2 1/4	336	\$1,678		\$1,678	\$3,342	\$2,461	
2 7/16	339	\$3,698		\$3,677	\$4,081	\$4,602	
2 1/2	340	\$3,698		\$3,677	\$4,081	\$4,974	
2 11/16	343	\$5,058		\$5,028	\$5,008	\$5,942	
2 15/16	347	\$5,275		\$5,243	\$6,522	\$6,825	
3	348	\$5,275		\$5,243	\$6,522	\$6,825	
3 7/16	355	\$7,475		\$7,431		\$9,277	
3 1/2	356	\$7,475		\$7,431		\$9,277	
3 15/16	363						

Nota: Tamaños 316, 339 a 363 son de origen USA, por lo tanto, debe aplicárseles el factor de productos importados.



LISTA DE PRECIOS

**CHUMACERAS Y REPUESTOS
SERIE 100**

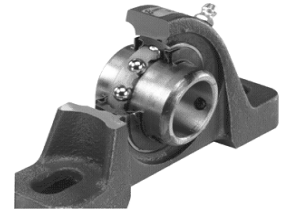

SERIE 100

EQUIVALENTES	BASE	BRIDA 2T	BRIDA 4T	TENSORA	BALERO RECTO
BROWNING	VPS-100	VF2S-100	VF4S-100	VTWS-100	SLS-100
DODGE	SC BASE	SC BRIDA 2T	SC BRIDA 4T	SC TENSORA	
SKF	SY-FM	FYT-FM	FY-FM	TBY-FM	
LINK BELT	P3-S200E	FX3-S200E	F3-S200E	TH3-S200E	
FAFNIR	SAS	SCJT	SCJ	VTU	

MEDIDA	NUMERO	TIPO	CHUMACERAS	BALERO RECTO
FLECHA PULG. Φ	Serie 100	BASE	VPS VPE	SLS -100 SLE-100
		BRIDA 2T	VF2S VF2E	
		BRIDA 4T	VF4S VF4E	
		TENSORA	VTWS VTWE	
		BASE Maleable	VPS -100M	
		BRIDA 3T Maleable	VF3S -100M	
		BRIDA 2T Maleable	VF2S -100M	



VF3S-100M
HIERRO MALEABLE

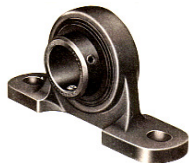

VPS-100M
HIERRO MALEABLE



VF2S-100M
HIERRO MALEABLE

1/2	108		\$396	\$337
5/8	110		\$396	\$337
3/4	112		\$396	\$337
7/8	114		\$445	\$379
15/16	115		\$445	\$379
1	116		\$445	\$379
1 1/8	118		\$523	\$445
1 3/16	119		\$523	\$445
1 1/4	120-S		\$523	\$445
1 1/4	120		\$603	\$513
1 3/8	122		\$603	\$513
1 7/16	123		\$603	\$513
1 1/2	124		\$721	\$613
1 11/16	127			
1 3/4	128		\$860	
1 15/16	131		\$933	
2	132-S		\$933	
2	132		\$1,081	
2 3/16	135		\$1,081	

SUFIJO "E" CON COLLARIN EXCENTRICO MISMO PRECIO
PUEDEN USAR REPUESTO DE LA SERIE 200

		SSF2S-116	\$627
VE-116	\$379	SSPB-116	\$864
VE-132	\$921	SSPS-119	\$479



LISTA DE PRECIOS



**RODAMIENTO DE BOLAS
SERIE "ER - BROWNING"**

SERIE ER BROWNING

Φ Diám. Int.	NUMERO ER - BROWNING	ANTERIOR VER - 200	PRECIO
1/2	ER-08 BROWNING	VER-208	\$342
5/8	ER-10 BROWNING	VER-210	\$446
3/4	ER-12 BROWNING	VER-212	\$376
7/8	ER-14 BROWNING	VER-214	\$389
15/16	ER-15 BROWNING	VER-215	\$389
1	ER-16 BROWNING	VER-216	\$389
1 1/16	ER-17 BROWNING	VER-217	
1 1/8	ER-18 BROWNING	VER-218	\$476
1 3/16	ER-19 BROWNING	VER-219	\$476
1 1/4	ER-20R BROWNING	VER-220S	\$476
1 1/4	ER-20 BROWNING	VER-220	\$576
1 3/8	ER-22 BROWNING	VER-222	\$576
1 7/16	ER-23 BROWNING	VER-223	\$576
1 1/2	ER-24 BROWNING	VER-224	\$652
1 9/16	ER-25 BROWNING	VER-225	
1 5/8	ER-26 BROWNING	VER-226	\$1,014
1 11/16	ER-27 BROWNING	VER-227	\$1,014
1 3/4	ER-28 BROWNING	VER-228	\$1,054
1 7/8	ER-30 BROWNING	VER-230	
1 15/16	ER-31 BROWNING	VER-231	\$845
2	ER-32 BROWNING	VER-232	\$1,028
2 3/16	ER-35 BROWNING	VER-235	\$1,028
2 1/4	ER-36 BROWNING	VER-236	\$1,242
2 7/16	ER-39 BROWNING	VER-239	\$1,242



LISTA DE PRECIOS

**CHUMACERAS Y REPUESTOS
SERIE 200 TRABAJO NORMAL MILIMETRICAS**

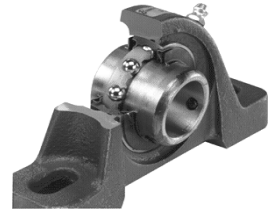

SERIE 200-mm

EQUIVALENTES	BASE	BRIDA 2T	BRIDA 4T	B. ROSCADA	REPUESTO
BROWNING	VPS-mm	VF2S-mm	VF4S-mm	VTBS-mm	VS-mm
DODGE	P2B-SC	F2B-SC	F4B-SC	TB-SC	
SKF	SY-TM	FYT-TM	FY-TM		
LINK BELT	P3-U200N	FX3-U200N	F3-U200N	PT3-U200N	
FAFNIR	RASC / YAS	RCJTC / YCJT	RCJC / YCJ		

Φ mm	NUM.	VPS-mm	VF2S-mm	VF4S-mm	VTBS-mm	VS-mm
-----------	------	--------	---------	---------	---------	-------

20	20mm	\$440	\$440	\$440	\$440	
25	25mm	\$523	\$523	\$523	\$523	
30	30mm	\$633	\$633	\$633	\$633	
35	35mm	\$737	\$737	\$737	\$737	
40	40mm	\$853	\$853	\$853	\$853	
45	45mm	\$902	\$902	\$902	\$902	
50	50mm	\$1,067	\$1,067	\$1,067	\$1,067	
55	55mm	\$1,244	\$1,244	\$1,244		
60	60mm	\$1,816	\$1,816	\$1,816		



LISTA DE PRECIOS



CHUMACERAS DE BOLAS
TRABAJO NORMAL

LINEA DE ORO
TRABAJO NORMAL

SEALMASTER									
Φ	NUM	NP BASE NPL BAJA SF BRD. 4T SFT BRD. 2T	FB BRIDA 3T	SP BASE	TB BASE ROSCADA	SFC BRIDA REDONDA	ST TENSORA	SC CARTUCHO	SCHB COLGANTE SEHB GRASERA
1/2	08	\$1,285	\$1,578		\$1,768				
9/16	09	\$1,279							
5/8	10	\$1,285	\$1,578		\$1,768				
11/16	11	\$1,279							
3/4	12	\$1,409	\$1,578		\$1,768		\$1,942		
7/8	14	\$1,525							
15/16	15	\$1,525							\$2,965
1	16	\$1,525	\$2,217	\$1,971	\$1,834		\$2,041	\$2,272	\$3,076
1 1/16	17	\$1,798					MX \$172		
1 1/8	18	\$1,807	\$2,517	\$2,383		\$2,292			\$2,965
1 3/16	19	\$1,807	\$2,526	\$2,382	\$2,169	\$2,301	\$2,391	\$2,464	\$3,076
1 1/4	20R	\$1,798	\$2,517		\$2,167	\$2,292	\$2,375	\$2,375	\$3,076
1 1/4	20	\$2,127	\$2,658	\$2,782	\$2,552	\$2,523	\$2,792	\$2,749	\$3,076
1 5/16	21	\$2,116							
1 3/8	22	\$2,127	\$2,647	\$2,783	\$2,550	\$2,513	\$2,774	\$2,650	
1 7/16	23	\$2,127	\$2,658	\$2,782	\$2,552	\$2,523	\$2,792	\$2,749	\$3,766
1 1/2	24	\$2,289		\$3,008		\$2,904	\$3,160	\$3,136	\$3,766
1 9/16	25	\$2,277			\$3,135	\$2,893		\$3,024	
1 5/8	26	\$2,659							
1 11/16	27	\$2,659					\$3,444	\$3,447	\$4,394
1 3/4	28	\$2,659		\$3,390			\$3,548	\$3,447	\$4,394
1 13/16	29	\$3,031						\$3,675	
1 7/8	30	\$3,031				\$3,628			\$4,236
1 15/16	31	\$3,046	\$3,294	\$3,942	\$3,660	\$3,643	\$3,699	\$3,812	\$4,394
2	32R	\$3,046	\$3,281		\$3,657	\$3,628	\$3,675	\$3,675	\$4,236
2	32	\$3,589		\$4,796		\$4,171	\$4,617	\$4,385	
2 1/8	34	\$3,571							
2 3/16	35	\$3,589		\$4,794		\$4,188	\$4,647	\$4,548	\$6,147
2 1/4	36	* \$4,826				\$5,238	\$5,661		\$6,596
2 3/8	38	* \$4,826				\$5,238		\$5,934	
2 7/16	39	* \$4,360		\$6,307		\$5,252	\$5,120	\$6,147	\$6,831
2 1/2	40	* \$6,639		\$8,811			\$7,913		
2 11/16	43	* \$5,997				\$7,387	\$8,196	\$8,263	
2 7/8	46	** \$6,083		\$9,297			\$9,070		
2 15/16	47	* \$7,254		\$9,280		\$8,404	\$9,394		\$9,920
3	48			\$14,775					\$11,986
3 3/16	51					\$9,884			\$11,986
3 1/4	52			\$16,623					
3 3/8	54			\$16,623					
3 7/16	55						\$16,459		

SUFIJO "C" CON SELLO DE CONTACTO PARA HUMEDAD, MISMO PRECIO EXCEPTO:

NP-39C \$4,841 SF-39C \$4,841 ** SF-46 \$8,030

SUFIJO "D" CON PISTA INTERIOR EXTENDIDA DOBLE (CONSULTAR HOJA A-13).

* SOLO SF, NP, NPL, Ver Excepciones











CHUMACERAS DE BOLAS
TRABAJO MEDIO

LISTA DE PRECIOS



LINEA DE ORO
TRABAJO MEDIO

SEALMASTER									
Φ	NUM	MP BASE	MSF BRIDA 4T	MSFT BRIDA 2T	MST TENSORA	MFC BRIDA REDONDA	MFP BASE 4T	EMP BASE EXPAN	MSC CARTUCHO

15/16	15		\$1,811			\$2,320		\$2,934	
1	16	\$2,162	\$1,807		\$2,473	\$2,386		\$2,943	
1 3/16	19	\$2,423	\$2,127		\$2,888	\$2,616		\$3,776	\$2,759
1 1/4	20	\$2,424	\$2,127	\$2,127	\$2,888	\$2,616			
1 7/16	23	\$2,803	\$2,289		\$3,268	\$3,012		\$4,420	
1 1/2	24	\$2,969	\$2,659		\$3,563			\$4,856	\$3,461
1 11/16	27	\$3,377	\$3,046	\$3,046	\$3,826	\$3,777		\$5,257	
1 3/4	28	\$3,379	\$3,046		\$3,826	\$3,777			\$3,826
1 15/16	31	\$3,856	\$3,589	\$3,589	\$4,806	\$4,343		\$5,904	\$4,565
2	32	\$3,854	\$3,596		\$4,673	\$4,223			\$4,439
2 3/16	35	\$4,701	\$4,360		\$5,297	\$4,901		\$7,148	
2 1/4	36	\$5,225	\$4,826			\$5,287			
2 7/16	39	\$6,054	\$6,658		\$8,234	\$7,663	\$8,680	\$9,399	
2 1/2	40	\$6,728	\$6,639		\$7,988	\$7,434			
2 11/16	43	\$7,934	\$8,055		\$9,438	\$8,721	\$9,799	\$12,518	
2 15/16	47	\$8,483	\$9,428		\$10,276	\$10,284	\$10,732	\$13,303	\$10,570
3	48	\$9,429	\$9,398		\$9,969	\$9,976			\$10,253
3 3/16	51	\$14,501	\$14,887		\$16,614			\$17,089	
3 1/4	52	\$14,501	\$14,887						
3 7/16	55	\$15,296	\$15,673			\$17,997	\$16,971	\$21,643	
3 1/2	56	\$15,296	\$15,673			\$17,997	\$16,971		\$17,296
3 15/16	63	\$24,471	\$23,513		\$26,598	\$27,200	\$25,753		
4	64	\$24,471	\$23,513			\$27,200	\$25,753		\$24,939

SUFIJO "C" CON SELLO DE CONTACTO PARA HUMEDAD, MISMO PRECIO EXCEPTO :
SUFIJO "D" CON PISTA INTERIOR EXTENDIDA DOBLE (CONSULTAR HOJA A-13).

MP-43C	\$8,819
--------	---------

VER ESPECIALIDADES EN LA HOJA A-12

SELLO DE FELPA
ESTÁNDAR



SEALMASTER
EXCLUSIVOS



SELLO DE CONTACTO
PARA HUMEDAD
"C"



LISTA DE PRECIOS

**LINEA DE ORO
CHUMACERAS DE BOLAS
CON COLLARIN SKWEZLOC
TRABAJO NORMAL**

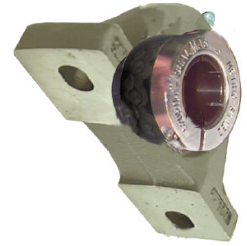

**SKWEZLOC
TRABAJO NORMAL**

SEALMASTER								
Φ	NUM	NP-T BASE NPL-T	SF-T BRIDA 4T	SFT-T BRIDA 2T	FB-T BRIDA 3T	SP-T BASE	TB-T B. ROSCADA	SFC-T BRIDA RED.

3/4	12 T	\$1,546		\$1,546	\$1,729			
15/16	15 T			\$1,675	\$2,422			
1	16 T	\$1,672	\$1,672	\$1,672	\$2,432	\$2,003	\$1,998	
1 1/8	18 T	\$1,987	\$1,987	\$1,987			\$2,379	\$2,517
1 3/16	19 T	\$1,983	\$1,983	\$1,983	\$2,771		\$2,381	
1 1/4	20 T	\$2,332	\$2,332	\$2,332	\$2,915		\$2,799	\$2,771
1 3/8	22 T	\$2,337	\$2,337	\$2,337	\$2,904			\$2,759
1 7/16	23 T	\$2,332	\$2,332	\$2,332	\$2,915			\$2,771
1 1/2	24 T	\$2,509	\$2,509	\$2,509		\$3,302	\$3,443	\$3,187
1 5/8	26 T	\$2,902	\$2,902	\$2,902				\$3,575
1 11/16	27 T	\$2,916		\$2,916				
1 3/4	28 T		\$2,916			\$3,715	\$3,685	\$3,590
1 15/16	31 T	\$3,344	\$3,344	\$3,344	\$3,614			\$3,992
2	32R T						\$4,015	\$3,976
2	32 T	\$3,947	\$3,947	\$3,947				\$4,573
2 1/8	34 T	\$3,919	\$3,919					\$4,573
2 3/16	35 T	\$3,939	\$3,939	\$3,939				
2 1/4	36 T		\$5,299					\$5,746
2 3/8	38 T							
2 7/16	39 T		\$5,315					\$5,763

SUFIJO "C" CON SELLO PARA HUMEDAD. (MISMO PRECIO).
NPL-T CAJA BASE BAJA CON SKWEZLOC
VER ESPECIALIDADES EN HOJA A-13

	ST-20T	\$3,153
	ST-23T	\$3,153
	ST-23TC	\$3,153

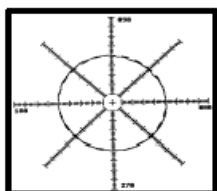

CONCENTRICIDAD
CON
SKWEZLOC
MEJOR CONCENTRICIDAD
MAS FACIL DE INSTALAR
NO DAÑA LA FLECHA

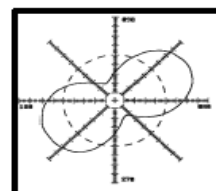

CONCENTRICIDAD
CON
OPRESORES A 45°









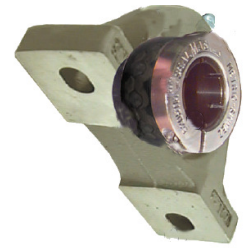

LISTA DE PRECIOS

**LINEA DE ORO
CHUMACERAS DE BOLAS
CON COLLARIN SKWEZLOC
TRABAJO MEDIO**



**SKWEZLOC
TRABAJO MEDIO**

SEALMASTER®								
Φ	NUM	MP-T BASE	MSF-T BRIDA 4T	MSFT-T BRIDA 2T	MST-T TENSORA	MFC-T BRIDA REDONDA	EMP-T BASE EXPAN	MSC-T CARTUCHO

1	16 T	\$2,371		\$1,983	\$2,712	\$2,620		\$2,657
1 3/16	19 T	\$2,658	\$2,332	\$2,332				
1 1/4	20 T	\$2,658	\$2,332			\$2,873		\$2,961
1 7/16	23 T	\$3,076		\$2,509			\$4,845	\$3,375
1 1/2	24 T	\$3,257		\$2,916				
1 11/16	27 T							
1 3/4	28 T	\$3,705				\$4,140		
1 15/16	31 T	\$4,235	\$3,939	\$3,939		\$4,762	\$6,476	
2	32 T	\$4,230	\$3,947	\$3,947		\$4,630		\$4,765
2 3/16	35 T	\$5,162			\$5,812	\$5,377	\$7,845	
2 1/4	36 T				\$5,715			
2 7/16	39 T						\$10,312	

SUFIJO "C" CON SELLO DE CONTACTO PARA HUMEDAD. (MISMO PRECIO).
VER ESPECIALIDADES EN HOJA A-13



REPUESTOS Y SERIE "ER"



ER Y REPUESTOS

Φ	SERIE - 2 - 		SERIE - 3 - 		SERIE ER 		SERIE ER-T SKWEZLOC 	
1/2	2-08	\$793			08	\$699	8 T	
5/8	2-010	\$793			10	\$699	10 T	
11/16					11	\$702	11 T	
3/4	2-012	\$793			12	\$696	12 T	\$901
7/8	2-014				14	\$739	14 T	\$872
15/16	2-015	\$1,277	3-15		15	\$758	15 T	
1	2-1	\$1,082	3-1	\$1,307	16	\$723	16 T	\$936
1 1/8	2-12	\$1,542			18	\$908	18 T	\$1,128
1 3/16	2-13	\$1,307	3-13	\$1,600	19	\$889	19 T	\$1,124
1 1/4	1-14	\$1,542			20R	\$932	20R T	
1 1/4	2-14	\$1,600			20	\$1,072	20 T	\$1,343
1 5/16	2-15	\$1,888			21	\$1,123	21 T	
1 3/8	2-16	\$1,888			22	\$1,094	22 T	\$1,349
1 7/16	2-17	\$1,600	3-17	\$1,761	23	\$1,072	23 T	\$1,343
1 1/2	2-18	\$1,761	3-18	\$1,946	24	\$1,214	24 T	\$1,525
1 9/16	2-19	\$2,078			25	\$1,272	25 T	
1 5/8	2-110	\$2,296			26	\$1,382	26 T	
1 11/16	2-111	\$1,946	3-111	\$1,996	27	\$1,376	27 T	
1 3/4	2-112	\$1,946	3-112	\$1,996	28	\$1,319	28 T	\$1,655
1 13/16	2-113	\$2,355						
1 7/8	2-114	\$2,355			30	\$1,644	30 T	
1 15/16	2-115	\$1,996	3-115	\$2,496	31	\$1,569	31 T	\$1,946
2	1-2	\$2,355						
2	2-2	\$2,946			32	\$1,870	32 T	\$2,363
2 1/8	2-22				34	\$1,977	34 T	
2 3/16	2-23	\$2,496	3-23	\$2,843	35	\$1,887	35 T	
2 1/4	2-24	\$3,729			36	\$2,370	36 T	
2 3/8	2-26	\$3,729			38	\$2,370	38 T	
2 7/16	2-27	\$3,160	3-27	\$5,016	39	\$2,262	39 T	\$2,772
2 1/2			3-28	\$5,918	40	\$3,422	40 T	
2 11/16	2-211	\$5,016	3-211	\$5,956	43	\$3,413	43 T	
2 7/8	2-214	\$7,028			46	\$4,450	46 T	
2 15/16	2-215	\$5,956	3-215	\$8,009	47	\$4,247	47 T	
3			3-3	\$9,451	48	\$5,140	48 T	
3 3/16	2-33		3-33	\$11,335	51	\$5,140		
3 1/4					52	\$7,064		
3 7/16	2-37	\$11,335	3-37	\$14,347	55	\$7,064		
3 1/2	2-38	\$14,347						
3 15/16			3-315	\$19,884	63	\$12,542		
4			3-4	\$19,884	64	\$12,542		
4 7/16			3-47D	\$43,293				
4 15/16			3-415D	\$48,358				

SUFIJO "C" CON SELLO DE CONTACTO PARA HUMEDAD. (MISMO PRECIO).
 VER SKWEZLOC Y ESPECIALIDADES EN HOJA A-13

ERX-19RL	\$1,774
ERX-20LO	\$1,050











LISTA DE PRECIOS







CHUMACERAS DE BOLAS
LINEA DE ORO MILIMÉTRICAS



**LINEA DE ORO
MILIMÉTRICAS**

TRABAJO NORMAL										
Φ mm	NUM	NP BASE	FB BRIDA 3T	SF BRIDA 4T	SFT BRIDA 2T	SFC BRIDA REDONDA	SC CARTUCHO	SERIE 5200 REPUESTO	ER	ER-T CON SKWEZLOC

20	204	\$1,401	\$1,572		\$1,401		\$2,068		\$1,232	
25	205		\$2,209		\$1,517		\$2,191		\$758	* \$1,279
30	206	\$1,798	\$2,517	\$1,798	\$1,798	\$2,292		\$1,542	\$932	* \$1,572
35	207	\$2,116	\$2,647		* \$3,431	\$2,513		\$2,027	\$1,123	* \$1,896
40	208	* \$3,693			\$2,277	\$2,893	\$3,024		\$1,272	* \$2,147
45	209				* \$4,290				\$1,382	* \$2,332
50	210	\$3,031	\$3,281		* \$4,914	* \$5,693	\$3,675	\$2,355	\$1,644	* \$2,774
55	211					\$4,171	\$4,385		\$1,977	
60	212			\$4,826		* \$6,468	\$5,934		\$2,370	* \$3,152
70	214					\$7,365			\$2,422	
75	215			\$8,030				\$7,028	\$4,450	
80	216								\$5,140	

TRABAJO MEDIO							
Φ mm	NUM	MP BASE	MFP BASE 4T	MSF BRIDA 4T	MSFT BRIDA 2T	MFC BRIDA REDONDA	SEHB COLGANTE C/GRASERA

20	304						
25	305	\$2,161					\$2,877
30	306				\$2,116	\$2,544	
35	307						
40	308					\$3,299	
45	309	\$3,375				\$3,673	
50	310	\$3,854	\$4,613			\$4,223	
55	311	\$4,699					
60	313					\$7,434	
70	314	\$8,818				\$8,459	
75	315			\$9,398			
80	316						

TB BASE ROSCADA	
TB-205	\$1,832
TB-206	\$2,167

OTROS:

5207TMC	* \$2,513
NP-206TMC	* \$2,915
SEHB-212C	\$6,596
SEHB-216	\$11,986
SFC-211TMC	* \$6,545
SFT-206TMC	\$2,915
ST-216	\$8,888

* SOLO CON SUFIJO TMC
CON COLLARIN SKWEZLOC

MST-315	\$9,969
MSC-306	\$2,683

SUFIJO "C" CON SELLO PARA HUMEDAD. (MISMO PRECIO).
SUFIJO "TMC" SELLO PARA HUMEDAD COLLARIN SKWEZLOC METRICO



LISTA DE PRECIOS

**CRES - CHUMACERAS ANTICORROSIVAS
SERIE PN GOLD - ACERO INOXIDABLE
BEVERAGE - INDUSTRIA EMBOTELLADORA**

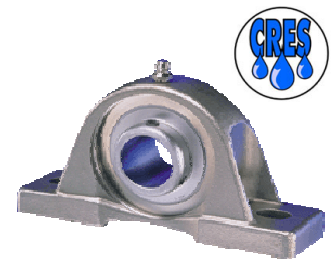

**SERIES CRES
ANTICORROSIVAS**

SERIE PN GOLD - CAJA DE ACERO INOXIDABLE Y REPUESTO AL ALTO FÓSFORO

Φ	NUM	CRPS-PN BASE	CRFS-PN BRIDA 4T	CRFTS-PN BRIDA 2T	CRSTF-PN TENSORA	CRFBS-PN BRIDA 3T	SEC CERRADA	SEO ABIERTA
3/4	12							
1	16	\$3,361	\$3,361	\$3,361	\$5,317			
1 3/16	19	\$3,927	\$3,927	\$3,927				
1 1/4	20R			CRFTC-PN \$2,813				
1 1/4	20	\$4,682						
1 7/16	23							
1 1/2	24		\$5,026				\$187	\$187
1 11/16	27							
1 15/16	31	\$6,727						
2	32R	\$6,727						
2	32	\$9,150	\$9,150	\$9,150	\$9,461			
2 3/16	35							
2 7/16	39	\$9,494						

SERIE BEVERAGE - CREADA ESPECIALMENTE PARA LA INDUSTRIA EMBOTELLADORA.

Φ	NUM	BF BRIDA 4T	BFT BRIDA 2T	FEC CERRADA 4T	FEO ABIERTA 4T	TEC CERRADA 2T	TEO ABIERTA 2T
1	16			\$215	\$215	\$215	\$215
1 3/16	19			\$215	\$215	\$215	\$215
1 1/4	20R				\$215		\$215
1 1/4	20	\$4,508	\$3,887		\$215		\$215
1 7/16	23			\$215	\$215	\$215	\$215
1 1/2	24		\$5,948	\$250	\$250	\$250	\$250
1 11/16	27			\$250	\$250	\$250	\$250
1 15/16	31			\$250	\$250	\$250	\$250
2 3/16	35			\$286	\$286	\$286	\$286
2 7/16	39						

TAMAÑO 20 UTILIZA TAPAS "F-23" Y "T-23" 20R UTILIZA TAPAS "T-19" Y "F-19"



LISTA DE PRECIOS



ESPECIALIDADES

1-2 T	\$2,798
2-012 T	\$1,007
2-1 T	\$1,311
2-110D	\$2,625
2-110T	\$2,705
2-115 T	\$2,379
2-12 T	\$1,837
2-13 T	\$1,557
2-14 T	\$1,875
2-17 T	\$1,875
2-18TC	\$2,071
2-2 D	\$3,375
2-23 D	\$2,861
2-27 T	\$3,772
2-2T	\$3,485
3-1 T	\$1,557
3-112 T	\$2,379
3-115 D	\$2,861
3-115 T	\$2,954
3-215 D	\$9,312
3-23 D	\$3,282
3-315 D	\$21,918
AR-1-2C	\$4,014
AR-2-011	\$2,010
AR-2-012C	\$1,996
AR-2-012T	\$2,190
AR-2-111	\$3,757
AR-2-112	\$3,757
AR-2-115	\$3,984
AR-2-14C	\$2,966
AR-216	\$17,769
AR-2-17	\$2,966
AR-2-17T	\$3,256
AR-2-18	\$3,486
AR-2-1C	\$2,293
AR-2-1T	\$2,514
AR-2-2	\$4,932
AR-2-215	\$11,674
AR-2-23	\$4,896
AR-3-115 T	\$5,375
AR-3-1TC	\$3,029
AR-3-215C	\$14,825
AR-3-4	\$39,264
EMP-205CXU	\$2,934
EMP-209CXU	\$5,241
EMP-23CXU	\$4,420
EMP-23HT	\$5,215
EMP-35CXU	\$7,148
ESF-24	\$4,760
ESF-31T	\$7,267
ESFC2400-C	\$36,279

FB-16C CR	\$3,748
FB-20C CR	\$4,585
HEC-23	\$822
HF-23	\$3,747
HF-28	\$5,116
HFC-23	\$1,104
HFT-19	\$4,270
MFCD-31	\$4,610
MFCD-35	\$5,231
MFCD-39	\$8,090
MFCD-43	\$9,385
MFCD-47	\$11,319
MFCD-55	\$19,717
MFCD-63	\$29,085
MFCH-24TC	\$3,722
MFPD-43	\$10,586
MFPD-63	\$27,473
MFPD-71	\$55,815
MFPD-79	\$60,287
MP-16 CXU	\$2,162
MP-23 CXU	\$2,803
MP-27CXU	\$3,377
MP-31TCXU	\$4,235
MPD-23	\$3,050
MPD-31	\$4,228
MPD-35	\$5,146
MPD-35CXU	\$5,146
MPD-39	\$7,498
MPD-39CXU	\$7,498
MPD-40	\$7,509
MPD-43	\$9,695
MPD-43CXU	\$9,695
MPD-47	\$10,734
MPD-47CXU	\$10,734
MPD-48	\$10,751
MPD-55	\$16,929
MPD-55CXU	\$16,929
MPD-63	\$26,262
MPD-63CXU	\$26,262
MSF-43CXU	\$8,055
MSFD-71	\$56,056
MSFD-79	\$60,551
MSFPD-39	\$9,959
MSFPD-47	\$13,913
MSFPD-55	\$17,747
MSFPD-63	\$27,835
MSFPD-71	\$55,941
MSFPD-79	\$60,426
MSPD-27	\$4,338
MSPD-31	\$4,957
MSPD-35	\$6,437

MSPD-39	\$9,959
MSPD-47	\$13,913
MSPD-48	\$13,887
MSPD-56	\$17,747
MSPD-63	\$27,835
MSPD-71	\$55,941
MSPD-79	\$60,426
NP-12TCXU	\$1,546
NP-16CXU	\$1,525
NP-16HT	\$1,895
NP-23TX	\$2,436
NP-24HT	\$2,922
NP-31TCXU	\$3,344
NP-32HT	\$3,582
NPD-20	\$2,276
NPD-22	\$2,267
NPD-26	\$2,846
NPD-31	\$3,265
NPD-35	\$3,843
NPG-14 to 16-9	\$6,055
NPG-17 to 19-9	\$7,195
NPG-20 to 23-12	\$7,605
NPG-24 to 28-12	\$7,842
NPG-30 to 31-12	\$9,820
NPG-30 to 31-18	\$11,133
NPG-32 to 35-18	\$14,721
PVR-1127	\$6,385
PVR-1507	\$6,534
PVR-1615	\$6,667
PVR-2535	\$6,257
RB-12C	\$721
RB-16C	\$739
RFP-115N	\$12,753
S-361-ML20	\$9,581
S-361-MR20	\$9,581
S-1762-MD20	\$8,650
SF-17MX	\$145
SF-24HT	\$2,922
SF-27MX	\$250
SFC2400-C	\$36,279
SFT-10-12C	\$1,409
SFT-15MX	\$200
SFT-16C CR	\$1,881
SFT-20C CR	\$2,624
SFT-23C CR	\$2,624
SFT-23TX	\$2,436
SFT-24C CR	\$2,824
SFT-26MX	\$250
SK-1310	\$7,700
SK-1484	\$1,085
SK-2775	\$1,185

SPB-110-C2	\$12,725
SPB-112-C2	\$14,411
SPB-200-C2	\$14,411
SPB-208-C2	\$18,325
SPB-2115-C2	\$7,948
SPB-308-C2	\$42,002
SPB-400-C4	\$60,068
SPD-22	\$3,017
SPD-24	\$3,271
SPD-31	\$4,201
SPD-40	\$9,512
SPD-47	\$10,191
SPG-36 to 39-12	\$11,460
SPG-40 to 47-12	\$19,401
SPM-19CXU	\$2,615
SPM-23CXU	\$2,830
SPM-27CXU	\$3,706
SPM-31CXU	\$4,508
SPM-35CXU	\$5,346
SPM-39CXU	\$8,270
SRC-08	\$737
SRC-12	\$737
SRC-16	\$795
SRC-19	\$1,065
SRC-20R	\$1,065
SRF-12	\$896
SRF-20R	\$1,194
SRP-16	\$964
ST-17MX	\$150
ST-24HT	\$3,681
STH-12 to 16-6	\$3,602
STH-17 to 19-6	\$4,476
STH-17 to 19-9	\$4,480
STH-20 to 23-9	\$3,939
STH-24 to 28-12	\$5,298
STH-30 to 31-18	\$7,709
STH-32 to 35-18	\$9,615
STH-36 to 39-18	\$12,129
STH-40 to 47-18	\$18,207
TFT-15TC1	\$1,864
TFT-16TC1	\$1,864
TFT-19TC1	\$2,000
TFT-20TC1	\$2,322
TFT-23TC1	\$2,322

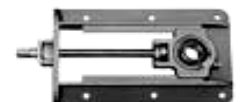

TENSOR STH
(no incluye la chumacera)

LISTA DE PRECIOS





SEALMASTER®

Browning®



CHUMACERAS DE RODILLOS CÓNICOS
RPB, TIPO D.I., K Y TIPO "E"



**RODILLOS
CÓNICOS**

Φ					
	PBE 920 E PB BASE 2T	PBE 920F E PB BASE 4T	FBE 920 E FB BRIDA	TUE 920 E TU TENSORA	PB 970 DI PB BASE

1 3/16	\$3,116		\$3,015		
1 1/4	\$3,116		\$3,015		
1 3/8	\$3,518		\$4,197		\$5,706
1 7/16	\$3,518		\$3,393	\$4,347	\$5,706
1 1/2	\$4,272		\$4,021	\$5,202	\$6,577
1 5/8	\$4,272		\$4,951		
1 11/16	\$4,272		\$4,021	\$5,202	\$6,577
1 3/4	\$4,775		\$4,649	\$5,856	\$7,882
1 15/16	\$4,448		\$4,649	\$5,856	\$7,834
2	\$4,448		\$4,649	\$5,856	\$7,834
2 3/16	\$5,026		\$5,277	\$7,237	\$9,430
2 1/4	\$6,031		\$7,237		\$9,439
2 7/16	\$5,604	\$6,031	\$5,604	\$6,911	\$10,833
2 1/2	\$6,031		\$6,031	\$8,093	\$10,833
2 11/16	\$9,298		\$9,298	\$12,414	\$13,057
2 3/4	\$9,298		\$10,982	\$12,414	
2 15/16	\$8,645	\$9,298	\$8,168	\$10,806	\$14,605
3	\$9,298	\$10,706	\$8,168		\$14,605
3 3/16	\$15,983		\$16,410		\$19,827
3 7/16	\$12,515	\$12,867	\$12,163	\$16,938	\$23,696
3 1/2	\$15,983	\$15,983	\$12,163		\$23,696
3 15/16		\$18,697	\$19,602	\$30,538	\$31,143
4		\$21,110	\$24,377		\$31,106
4 7/16		\$30,408		\$49,395	\$47,512
4 1/2		\$32,670			\$47,512
4 15/16		\$40,712			\$59,626
5		\$52,146			\$59,626

NUM		
	RPB BASE 2T-4T	RFP / RFA BRIDA REDONDA

103-2		
104-2	\$6,363	
106-2		
107-2	\$7,209	
108-2	\$7,989	
110-2	\$7,989	
111-2	\$7,989	\$9,154
112-2	\$9,090	
115-2	\$9,090	\$10,524
200-2	\$9,090	\$10,524
203-2	\$10,183	\$11,572
204-2		
207-2	\$11,426	\$13,096
208-2	\$11,426	\$13,096
211-2	\$17,533	
212-2	\$17,533	\$19,867
215-2	\$17,533	\$19,838
300-2	\$17,533	\$19,838
303-2		
307-2	\$26,230	
308-2	\$26,230	\$29,606
315-4	\$37,665	\$42,855
400-4	\$37,665	
407-4	\$67,028	\$70,123
408-4		\$70,123
415-4		\$97,334
500-4		\$97,334

BROWNING - CAJA DE HIERRO MALEABLE

Φ	PB900	FC900	FB900	PB950E	PB950NE
	E BASE	E B. RED.	E BRIDA	K BASE	K BASE
1 "			\$5,176		
1 1/2		\$7,799	\$6,962	\$9,330	\$9,330
1 5/8				\$9,330	\$9,330
1 7/8				\$10,670	\$10,670
2 7/16		\$11,144			
2 1/2	\$9,697			\$16,027	\$16,027
2 15/16	\$14,783	\$16,931			
3	\$14,783				
3 3/16		\$25,294			
3 15/16	\$32,019				
4 7/16			\$54,251		

SEALMASTER

NUM	RFB	RCI
	BRIDA 4T	REPUESTOS
104	\$6,573	112C \$7,458
108C	\$8,551	208 \$9,379
115C	\$9,780	212 \$14,385
203N		215 \$14,385
		400 \$30,900

NUM	ERPB	ERCI
	202-2	\$10,892
315-4	\$45,197	

FB970NE 3"	\$17,288
------------	----------



LISTA DE PRECIOS

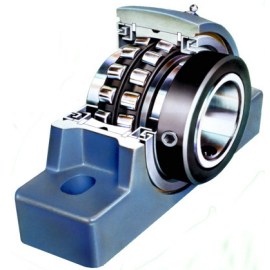

CHUMACERAS DE RODILLOS ESFERICOS 1000
EXPANSION Y NO EXPANSION

RODILLOS
ESFERICOS

EQUIVALENTES	BASE	BASE 4T	BRIDA 4T	B. REDONDA	TENSORA
BROWNING	SPB 1000	SPB 1000F	SFB 1000	SFC 1000	STU 1000
DODGE	S-2000 BASE 2	S-2000 BASE 4	S-2000 BRIDA	S-2000 B. RED.	S-2000 TENS.
SKF	SYR	FSYE	FYR	FYRP	
LINK BELT	P-B22400	P-B22400F	F-B22400	FC-B22400	T-B22400

BROWNING	SPB 1000	SPB 1000F	SFB 1000	SFC 1000	STU 1000
MEDIDA	BASE	BASE 4T	BRIDA 4T	B. REDONDA	TENSORA

1-3/16	\$3,542				
1-7/16	\$4,015		\$4,115	\$4,659	
1-1/2	\$4,015		\$4,115	\$4,659	
1-11/16	\$4,782		\$4,820	\$5,481	
1-3/4	\$4,782		\$4,820	\$5,481	
1-15/16	\$5,415		\$5,571	\$6,282	\$5,913
2	\$5,415		\$5,571	\$6,282	\$5,913
2-3/16	\$6,089		\$6,268	\$6,881	\$7,346
2-7/16	\$6,815	\$6,815	\$7,031	\$7,777	\$8,143
2-1/2	\$6,815	\$6,815	\$7,031	\$7,777	\$8,143
2-11/16	\$10,413	\$10,413	\$10,625	\$11,795	\$11,888
2-3/4	\$10,413	\$10,413	\$10,625	\$11,795	\$11,888
2-15/16	\$10,413	\$10,413	\$10,625	\$11,795	\$11,888
3	\$10,413	\$10,413	\$10,625	\$11,795	\$11,888
3-3/16	\$15,559	\$15,559	\$16,061	\$17,607	\$17,301
3-7/16	\$15,559	\$15,559	\$16,061	\$17,607	\$17,301
3-1/2	\$15,559	\$15,559	\$16,061	\$17,607	\$17,301
3-11/16	\$22,285	\$22,285	\$23,435	\$25,242	\$28,574
3-15/16	\$22,285	\$22,285	\$23,435	\$25,242	\$28,574
4		\$22,285	\$23,435	\$25,242	\$28,574
4-7/16		\$35,459			
4-1/2		\$42,216			
4-15/16		\$49,006			

E - EXPANSIÓN NE - NO EXPANSION MISMO PRECIO
C - SELLO DE CONTACTO MISMO PRECIO
PARA MAS INFORMACION VER CATALOGO BMB.